

Application areas

Drinking water supply for:

- > Domestic kitchens
- > Public areas
- > Offices
- > Cafeterias / bistros
- > Restaurants / hotels



Water system

Zip HydroTap® G5 BC

Product information



boiling >  chilled >  **G5 BC 20**

Part number:	4100-44595
Number of users:	< 20
Water connection (thread connection):	G ½" or G ¾" *
Rated pressure [bar]:	1.7 – 7.0
Boiling water temperature, adjustable [°C]:	68 – 100
Chilled water temperature, adjustable [°C]:	5 – 15
Boiling water content [litres / cups ¹⁾]:	2.3 / 13
Chilled water content [litres / glasses ²⁾]:	1.8 / 9
Chilled water capacity [glasses ²⁾ / h]:	75
Boiling water capacity [cups ¹⁾ / h]:	100
Reheating time [cups ¹⁾ / min]:	1.6
Standby power consumption [kWh / 24h]:	0.75 ³⁾
Nominal power at voltage 1~/N/PE 230 V AC [kW]:	1.9  with plug
Undersink unit [colour]:	white
Protection class:	IP 20
Weight (filled) [kg]:	23
Dimensions (height × width × depth) [cm]:	33.3 × 28.0 × 45.5

*) Connection hose G ½" with supplied adapter G ¾" 1) Standard cup with 167 ml 2) Standard glass with 200 ml 3) At 12 hours in standby mode

Description

- > Undersink water system, dispenses filtered boiling hot water and chilled still drinking water for direct connection to an angle valve
- > Touch display for menu navigation, for activating the energy saver modus and scalding protection as well as temperature setting of the water
- > With R290 coolant to meet the latest environmental and climate protection requirements
- > Electronic temperature control
- > Easy-to-replace sub-micron particle filter cartridge with activated carbon filter, filters hazardous substances > 0.2 micron and improves the taste of water
- > Leakage protection system
- > Various electronic taps with safety function and button operation selectable

Profitability comparison (Source: Internet comparison, 18.11.2018)

The comparison shows the total costs of the various systems including purchase, energy and maintenance costs over 5 years of use in Germany. Ideal for use in the office.

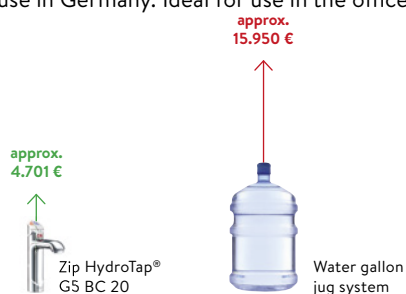

Calculation basis

Number of users:	15 persons
Number of days in use:	230 working days per year
Usage:	0.9 litres / person and day
Drinking water costs:	4 € per 1.000 litres
Water gallon jugs:	950 € per 1.000 litres

Water system

Zip HydroTap® G5 BC

Installation



Daily user requirements and the available space in the cabinet below the selected special tap should be considered when selecting the appropriate model.

Measurements in mm

Assembly and operating instructions must be observed upon installation.

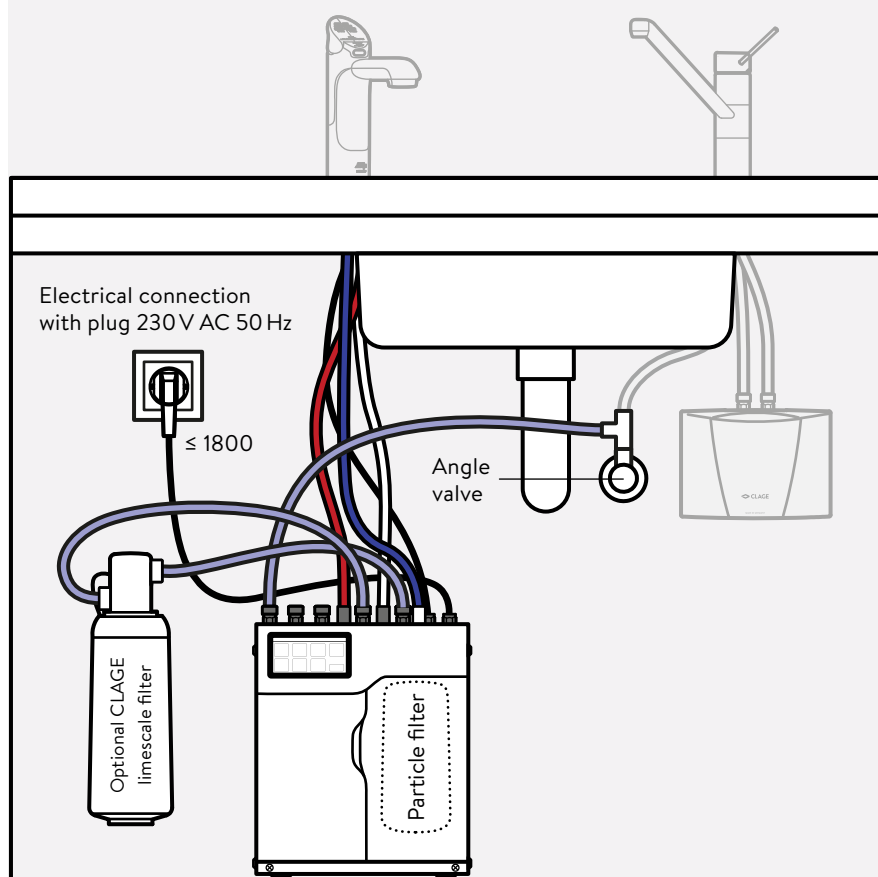

Unit dimensions:
(height × width × depth)

Zip HydroTap® G5 BC 20
333 × 280 × 455 mm

Top clearance for undersink unit
(lower edge sink or drawers)
min. 200 mm

Right and left clearance for unit
min. 50 mm

Water system Zip HydroTap® G5 BC Installation

Option 1: Tap “Classic BC”

Measurements in mm

For the operation of the water system Zip HydroTap® G5 BC you need a suitable tap, for example the tap “Classic BC”.

Assembly and operating instructions must be observed upon installation.

NEW!

Now also available as **Touch-Free** option with IR sensors for no-touch operation. Requires min. 10 cm free space around the sensor head.

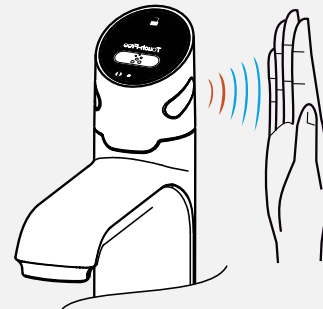

NEU!

Now also available as option **Classic Plus** with waterproof rubber surface and separate quantity fill button.

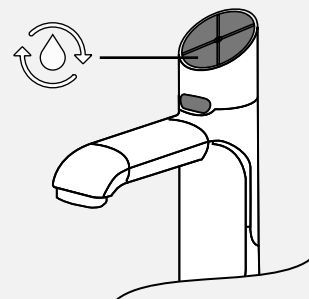

Drill hole diameter
for the tap

$\varnothing 35,5$
max. 50
min. 25

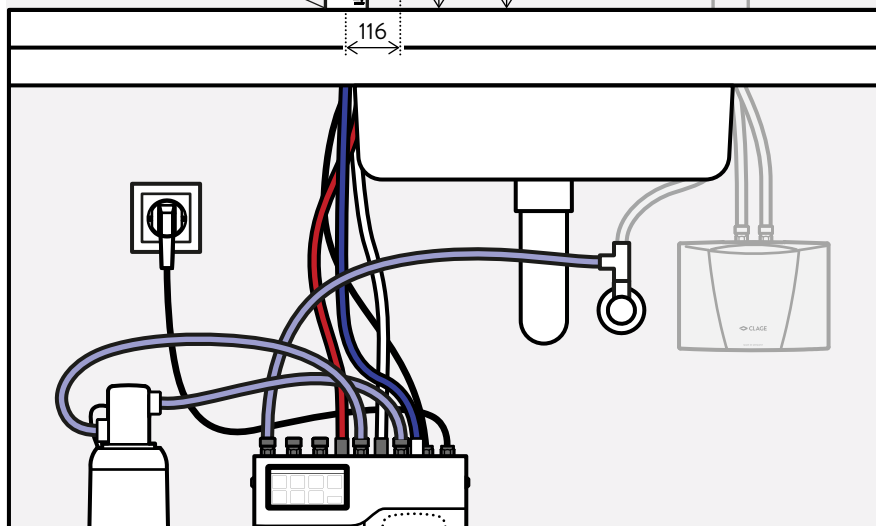
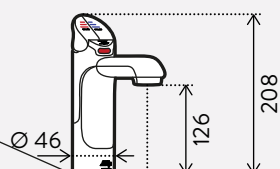

Installation at the kitchen sink



Installation as stand-alone unit with drainage front and extension KXTV.



Water system Zip HydroTap® G5 BC Installation

Option 2: Tap “Arc BC”

Measurements in mm

For the operation of the water system Zip HydroTap® G5 BC you need a suitable tap, for example the tap “Arc BC”.

Assembly and operating instructions must be observed upon installation.

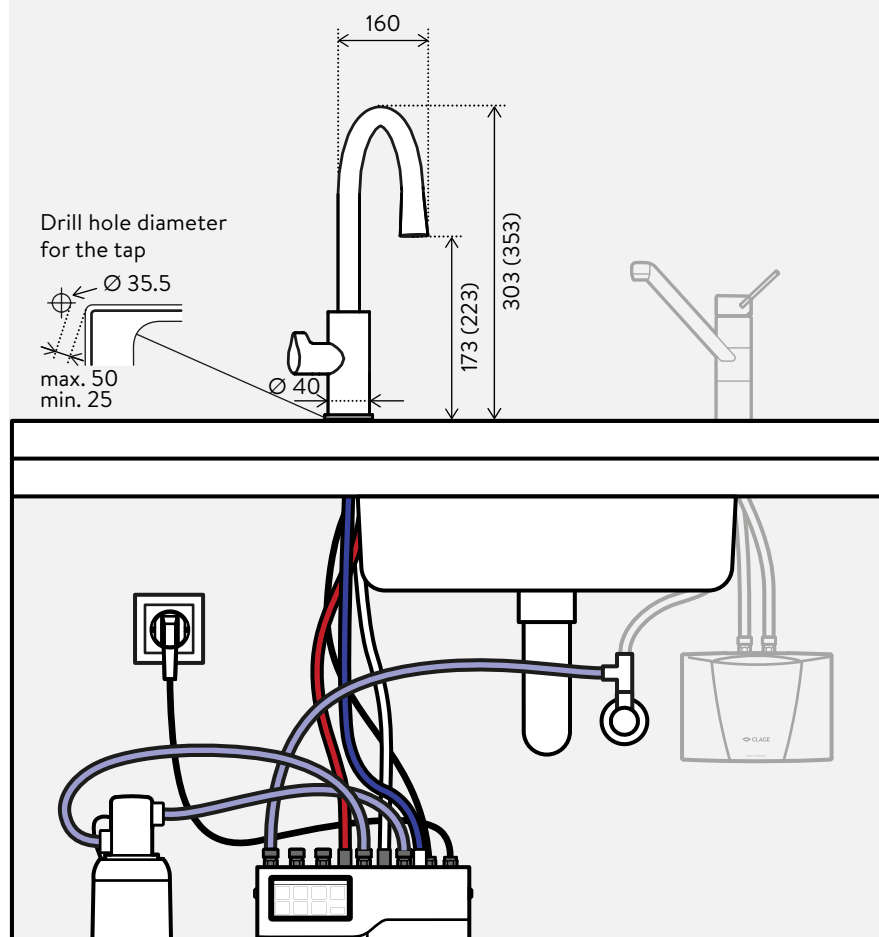

Flexible alignment

The Arc can be installed for left and right hand operation and the pipe outlet can be fixed at various angles and heights.

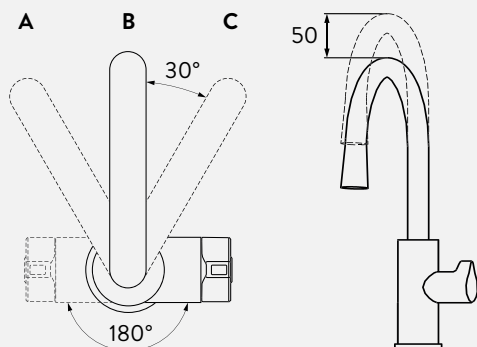

Installation as stand-alone unit with drainage front KXT.



Water system

Zip HydroTap® G5 BC

Taps



Zip Classic BC

Electronic dispensing tap for Zip HydroTap® BC with operating keys at the top, function indicator, holding function for easy canister filling, fixed spout 12 cm, height 21 cm, drill hole with 35 mm diameter required.

Classic BC, polished chrome: Part no. 4100-44506
Classic BC, brushed chrome: Part no. 4100-44507
Classic BC, matte black: Part no. 4100-44508



Zip Classic Plus BC

Electronic dispensing tap for Zip HydroTap® BC with operating keys at the top, function indicator, fill button for easy canister filling, fixed spout 12 cm, height 21 cm, drill hole with 35 mm diameter required.

Classic Plus BC, polished chrome: Part no. 4100-44806
Classic Plus BC, brushed chrome: Part no. 4100-44807
Classic Plus BC, matte black: Part no. 4100-44808



Zip Touch-Free BC

Electronic dispensing tap for Zip HydroTap® B with IR sensors and function indicator for hygienic, no-touch operation, free space of min. 10 cm around the sensor head needed, fixed spout 12 cm, height 21 cm, drill hole with 35 mm diameter required.

Touch-Free BC, polished chrome: Part no. 4100-44541



Zip Arc BC

Electronic dispensing tap for Zip HydroTap® BC with operating lever on the side, function indicator, holding function for easy canister filling, fixed spout 16 cm, height 35.3 cm, drill hole with 35 mm diameter required.

Arc BC, polished chrome: Part no. 4100-44509
Arc BC, brushed chrome: Part no. 4100-44510
Arc BC, matte black: Part no. 4100-44511



KXV for Classic (optional)

The optional extension for raising the electronic dispensing tap Zip Classic by 13.5 cm.

KXV , polished chrome:	Part no. 4100-44165
KXV , brushed chrome:	Part no. 4100-44166
KXV , matte black:	Part no. 4100-44167



KXTV for Classic (optional)

The optional stainless steel font with drainage connection and extension allows for flexible installation of the electronic dispensing tap at any location away from the sink. Suitable for worktops and surfaces up to 40 mm thick.

KXTV , polished chrome:	Part no. 4100-44565
KXTV , brushed chrome:	Part no. 4100-44566
KXTV , matte black:	Part no. 4100-44567



KXTV Pro for Classic / Classic Plus / Touch-Free (optional)

The optional stainless steel font with drainage connection and extension allows for flexible installation of the electronic dispensing tap at any location away from the sink. Suitable for worktops and surfaces up to 40 mm thick.

KXTV Pro , polished chrome:	Part no. 4100-44570
KXTV Pro , brushed chrome:	Part no. 4100-44571
KXTV Pro , matte black:	Part no. 4100-44572



KXT for Arc (optional)

The optional stainless steel font with drainage connection allows for flexible installation of the electronic dispensing tap at any location away from the sink. Suitable for worktops and surfaces up to 40 mm thick.

KXT , polished chrome:	Part no. 4100-44560
KXT , brushed chrome:	Part no. 4100-44561
KXT , matte black:	Part no. 4100-44562



KXF 2.1 (included)

Sub-micron particle filter cartridge filters contaminants > 0.2 microns and additionally improves the taste of the water.
For Zip HydroTap® G4 models from 02.2017.

KXF 2.1: Part no. 893702



Filter system CLARIS ULTRA for water softening (optional)

For hard, chalky water, the filter system CLARIS ULTRA is to be used (recommended from 10 °KH).

Filter head suitable for all CLARIS ULTRA-filter

Filter head Universal: Part no. 84519

Filter cartridge, capacity at 10 °KH 4.200 litre

CLARIS ULTRA 500: Part no. 84500

Filter cartridge, capacity at 10 °KH 8.500 litre

CLARIS ULTRA 1000: Part no. 84501

Filter cartridge, capacity at 10 °KH 20.000 litre

CLARIS ULTRA 2000: Part no. 84502



DTK (optional)

The digital temperature controller for Zip devices is used to keep the temperature in the cupboard below 35 °C when normal ventilation is not sufficient. The digital controller operates independently of the undersink unit and will require a separate 230 V socket.

DTK: Part no. 893159